

# 1317 CORDELL PLACE

LOS ANGELES, CA 90069



All measurements are approximate. While deemed reliable, no information on these floor plans should be relied upon without independent verification.

# 1317 CORDELL PLACE

LOS ANGELES, CA 90069

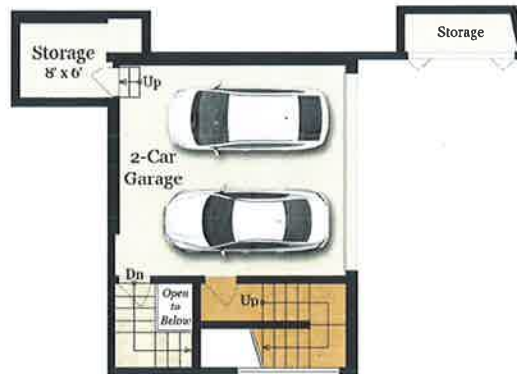

## MAIN RESIDENCE GARAGE LEVEL

150 SQ FT - Finished  
480 SQ FT - Unfinished



## MAIN RESIDENCE LOWER LEVEL

(Below Garage)  
160 SQ FT

### Estimated Total Finished Square Footage: 2,880 SQ FT

Above-Grade: 2,570 SQ FT Below-Grade: 310 SQ FT  
Calculated per ANSI Standard Z765-2003

- Main Residence: 2,640 SQ FT
  - Main Level: 2,330 SQ FT
  - Garage Level: 150 SQ FT
  - Lower Level: 160 SQ FT
- Artist Cottage: 240 SQ FT

### Unfinished Square Footage: 480 SQ FT

- Storage (Main House-Garage Level): 115 SQ FT
- 2-Car Garage (Main House-Garage Level): 365 SQ FT

### Estimated Total Finished & Unfinished Square Footage: 3,360 SQ FT



All measurements are approximate. While deemed reliable, no information on these floor plans should be relied upon without independent verification.